

10/31/2025 5:11 PM USER: tony PATH: C:\Projects\10155 Adams TESC Plan (McFadden)\cad\Adams TESC (2025-10-31).dwg

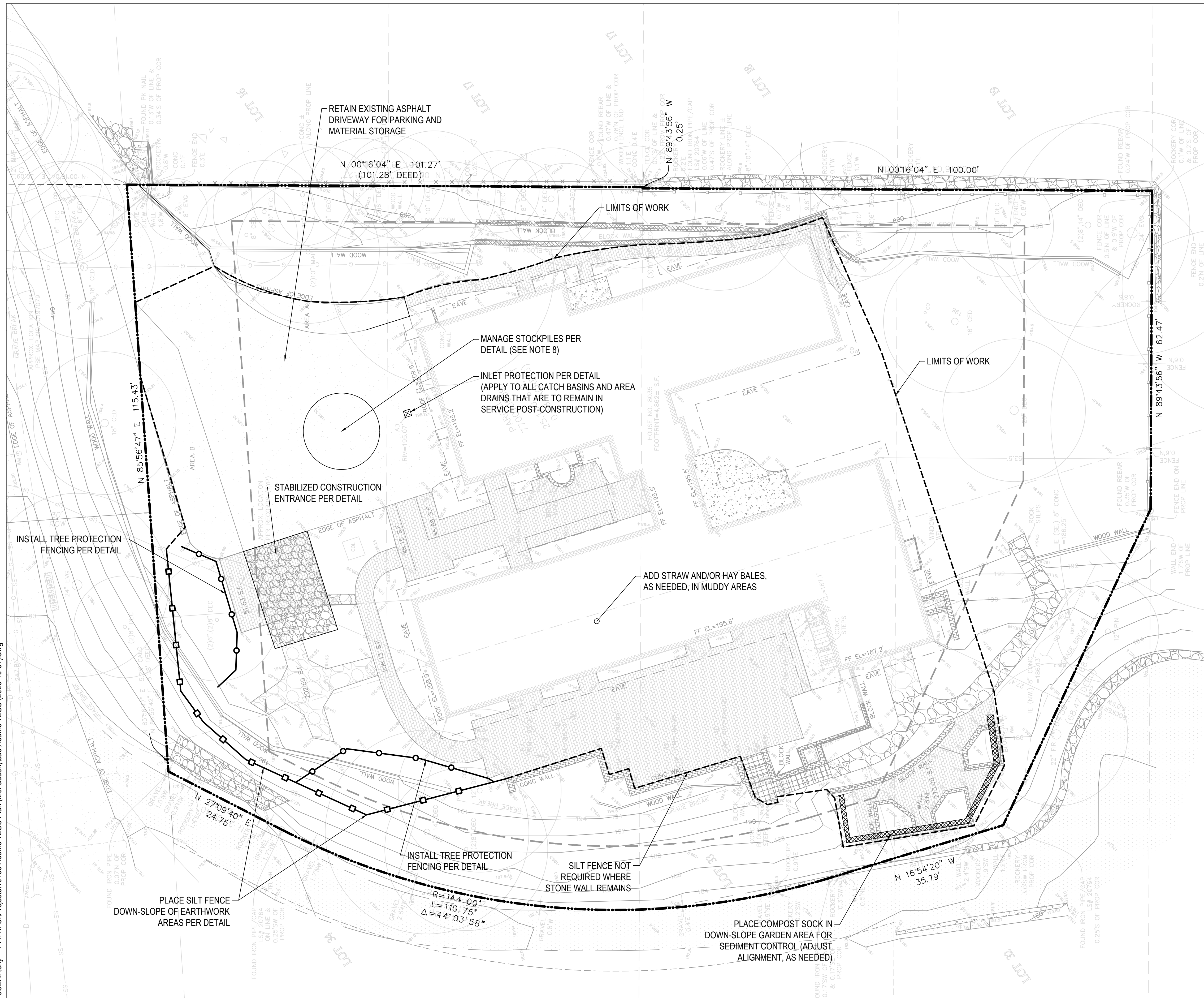

- ### EROSION AND SEDIMENT CONTROL NOTES
1. SEE BMP DETAILS ON SHEET C-02, C-03
 2. ALL EROSION CONTROL BMPs MUST BE INSTALLED FOR EXTENT OF EARTHWORK
 3. ALL MATERIAL DELIVERY AND STORAGE MUST CONDUCTED TO PREVENT SPILLAGE AND LEAKAGE
 4. PROJECT CONTACT SHEET SHALL BE COMPLETE AND MAINTAINED ON SITE
 5. ANY INSPECTION FORMS REQUIRED BY MERCER ISLAND SHALL BE KEPT ON SITE
 6. CLEARING LIMITS AS INDICATED BY FILTER FENCE SHALL BE MAINTAINED THROUGHOUT CONSTRUCTION
 7. CONTRACTOR TO REVIEW AND COMPLY WITH THE FOLLOWING BMPs IN THE 2019 STORMWATER MANUAL FOR WESTERN WASHINGTON: C151 MATERIAL HANDLING, C152 SAWCUTTING AND SURFACE POLLUTION PREVENTION, C153 MATERIAL DELIVERY, STORAGE, AND CONTAINMENT, C154 CONCRETE WASHOUT AREA
 8. CONTRACTOR MAY ADJUST STOCKPILE LOCATION THROUGHOUT CONSTRUCTION, AS NEEDED

CONSTRUCTION SWPPP NARRATIVE

NO.	ELEMENT	APPROACH/REFERENCE
1	MARK CLEARING LIMITS, DISTURBANCE AREAS	THE CLEARING LIMITS AND INSTALL LOCATION FOR FILTER/SILT FENCING ARE INDICATED ON THE EROSION AND SEDIMENT CONTROL SHEET (C-01).
2	ESTABLISH CONSTRUCTION ACCESS	PROTECT EXISTING DRIVEWAY/AUTO COURT AND INSTALL STABILIZED CONSTRUCTION ENTRANCE.
3	CONTROL FLOW RATES	ANY RUNOFF FROM HARD SURFACES DURING CONSTRUCTION WILL BE MITIGATED WITH A) FILTER/SILT FENCING AND SUPPLEMENTAL EROSION CONTROLS (E.G., COMPOST SOCK), AS NEEDED.
4	INSTALL SEDIMENT CONTROLS	SEDIMENT FROM HARD SURFACES DURING CONSTRUCTION WILL BE MITIGATED WITH FILTER/SILT FENCING AND SUPPLEMENTAL EROSION CONTROLS (E.G., COMPOST SOCK), AS NEEDED.
5	STABILIZE SOILS	EXPOSED SOILS WILL BE PROTECTED WITH STRAW OR PLASTIC (PER STOCKPILE DETAIL).
6	PROTECT SLOPES	PLASTIC SHEETING OR STRAW WILL BE USED, AS NEEDED, TO SUPPLEMENT SLOPE PROTECTION.
7	PROTECT DRAIN INLETS	STORM DRAIN INLETS WILL BE PROTECTED AS SHOWN ON C-03.
8	STABILIZE CHANNELS	THERE ARE NO EXISTING CHANNELS OR OUTLETS IN THE PROJECT AREA.
9	CONTROL POLLUTANTS	USAGE OF HAZARDOUS CHEMICALS ONSITE WILL BE MINIMIZED. ANY SUCH MATERIALS WILL BE DELIVERED SHORTLY BEFORE USE AND WILL BE ENCLOSED AND COVERED. EXCAVATION AND STOCKPILES WILL BE COVERED AS SHOWN IN SHEET C-02 DETAIL. ALSO, SEE NOTE 7 ABOVE.
10	CONTROL DEWATERING	NO DEWATERING IS EXPECTED DURING CONSTRUCTION.
11	MAINTAIN BMPs	SWPPP BMPs WILL BE INSPECTED AFTER EACH RAINFALL AND WEEKLY DURING DRY PERIODS TO IDENTIFY AND CONDUCT REPAIRS.
12	MANAGE THE PROJECT	THE TESC PLAN AND CSWPPP NARRATIVE WILL BE KEPT ONSITE. THE PROJECT LEAD WILL MAINTAIN A PROJECT LOG THAT DOCUMENTS MATERIAL DELIVERIES, PROJECT RECEIPTS, AND INSPECTIONS.
13	PROTECT LID BMPs	THERE ARE NO EXISTING AND PROPOSED LID BMPs ON THE PROJECT SITE.

4218 Meridian Ave N
Seattle, WA 98103
206-898-0057
www.dubinenv.com



NO.	REVISION	BY	DATE	APPR

SCALE: 1" = 10'

ONE INCH AT FULL SCALE IF NOT ONE INCH SCALE ACCORDINGLY

VERTICAL: NAD 1988 HORIZONTAL: NAD 1983/1991

DATUM

NORTH ARROW

ADAMS RESIDENCE
8035 SE 45TH ST
MERCER ISLAND, WA 98040
PARCEL# 7700100091

TEMPORARY EROSION AND SEDIMENT CONTROL PLAN

DATE: 10/31/2025
FIELDBOOK: _____
PAGE: _____
DRAWING NO.: _____
SHEET: C-01

STOCKPILE AND EXPOSED SLOPE COVERING

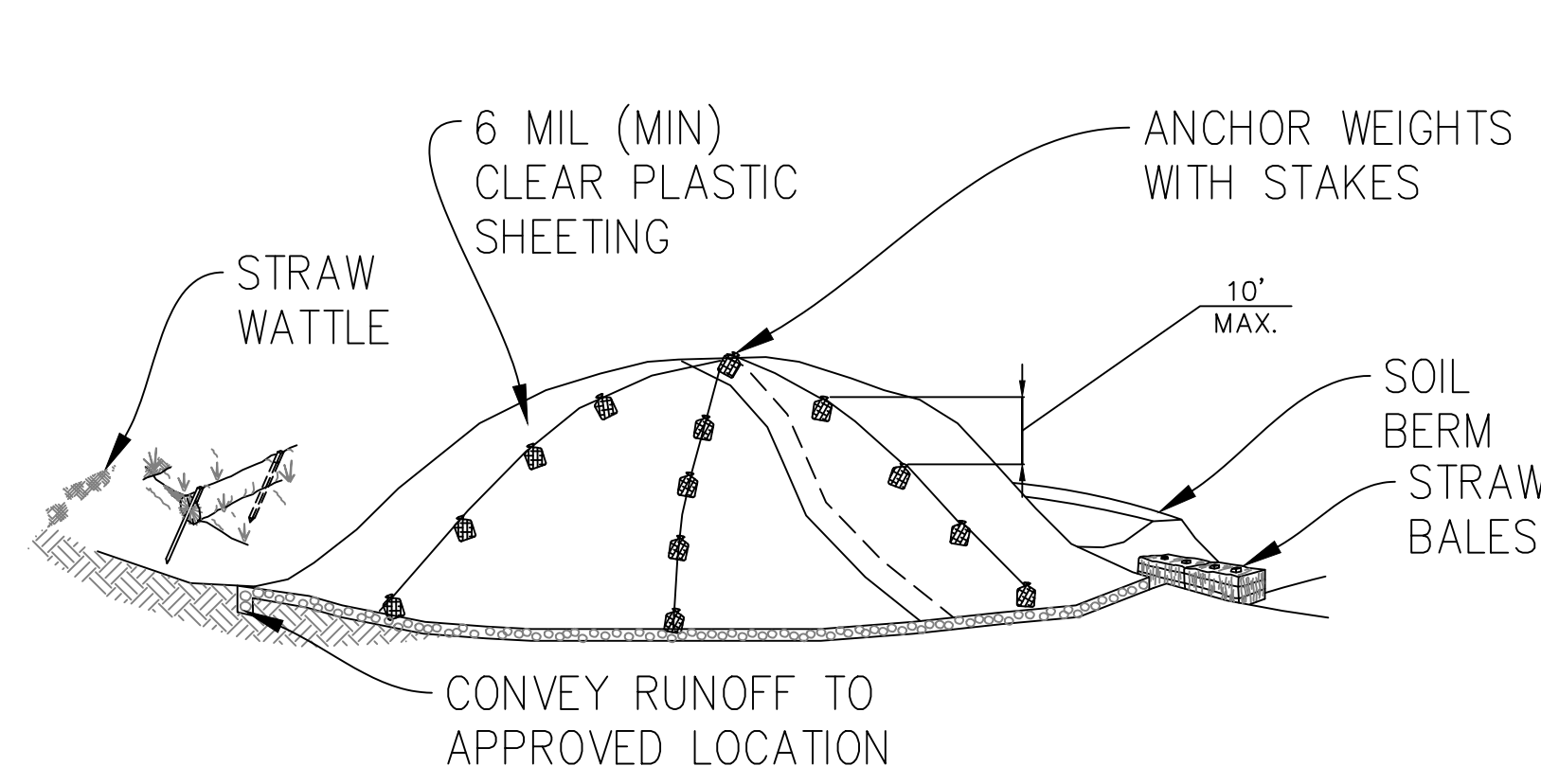

STOCKPILES

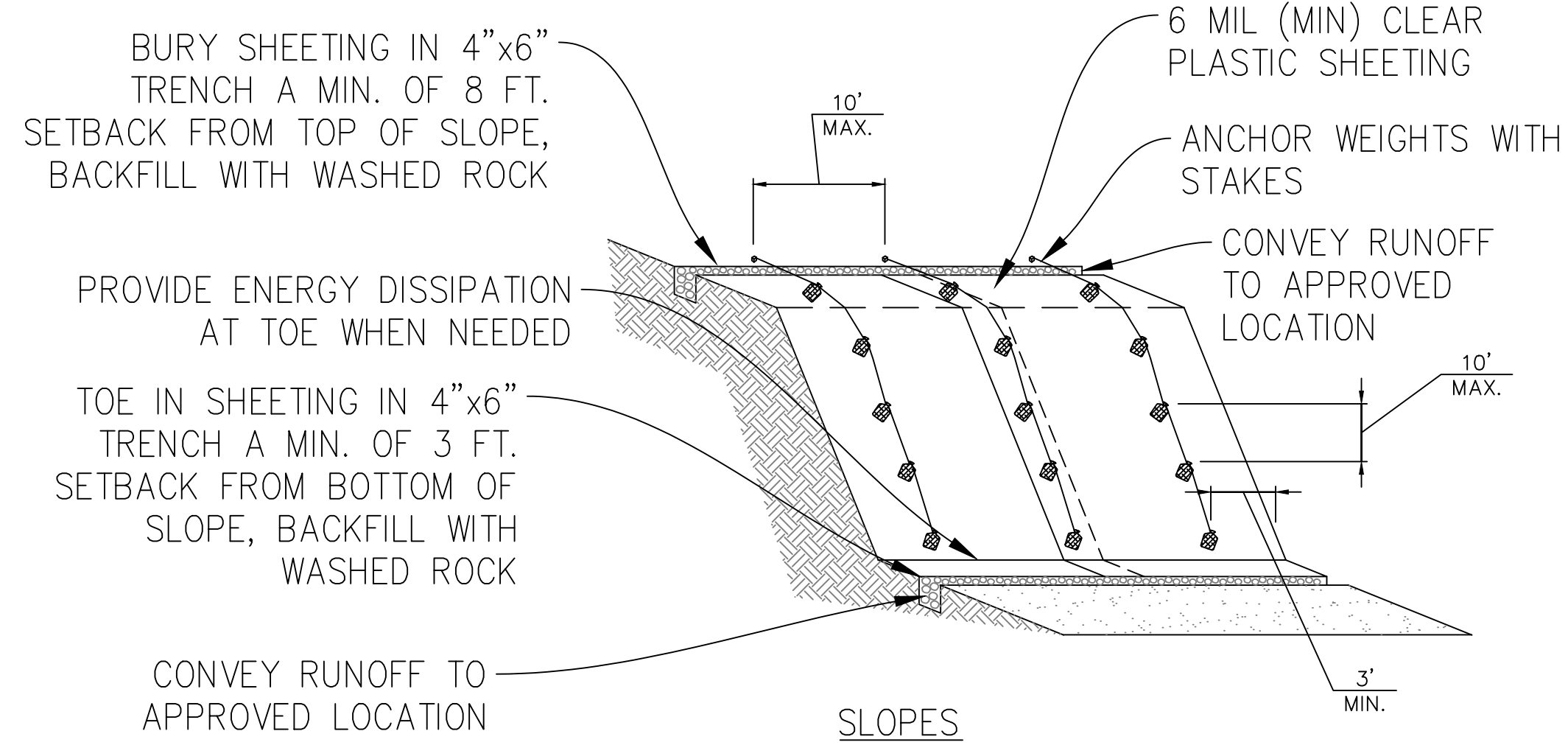

SLOPES

DRAWN BY: BILL BERENS

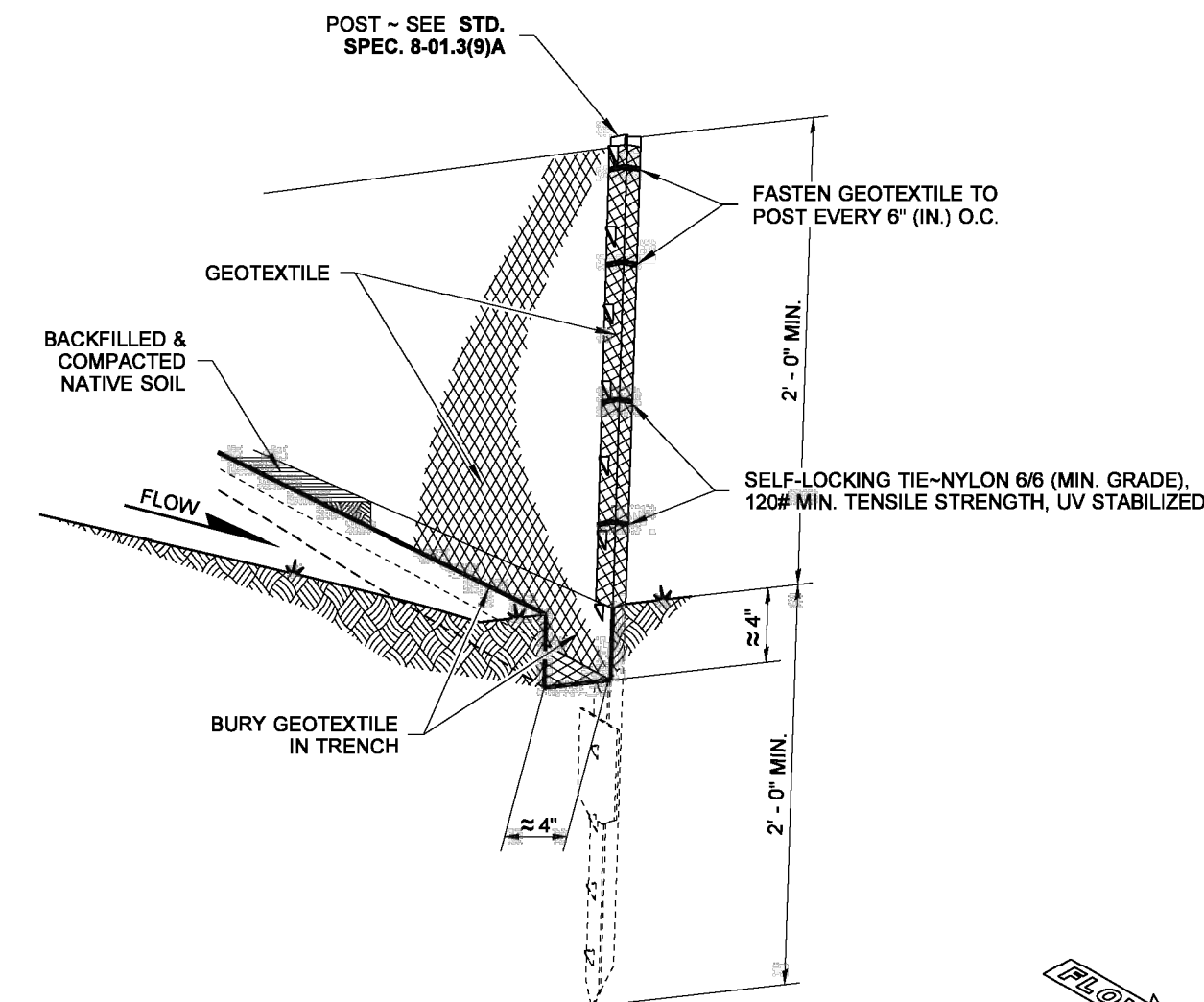

NOTE
DURING EXCAVATION, MINIMIZE DISTURBING THE GROUND AROUND TRENCH AS MUCH AS IS FEASIBLE, AND SMOOTH SURFACE FOLLOWING EXCAVATION TO AVOID CONCENTRATING FLOWS. COMPACTION MUST BE ADEQUATE TO PREVENT UNDERCUTTING FLOWS.

TYPICAL INSTALLATION DETAIL
(STEEL POSTS SHOWN)

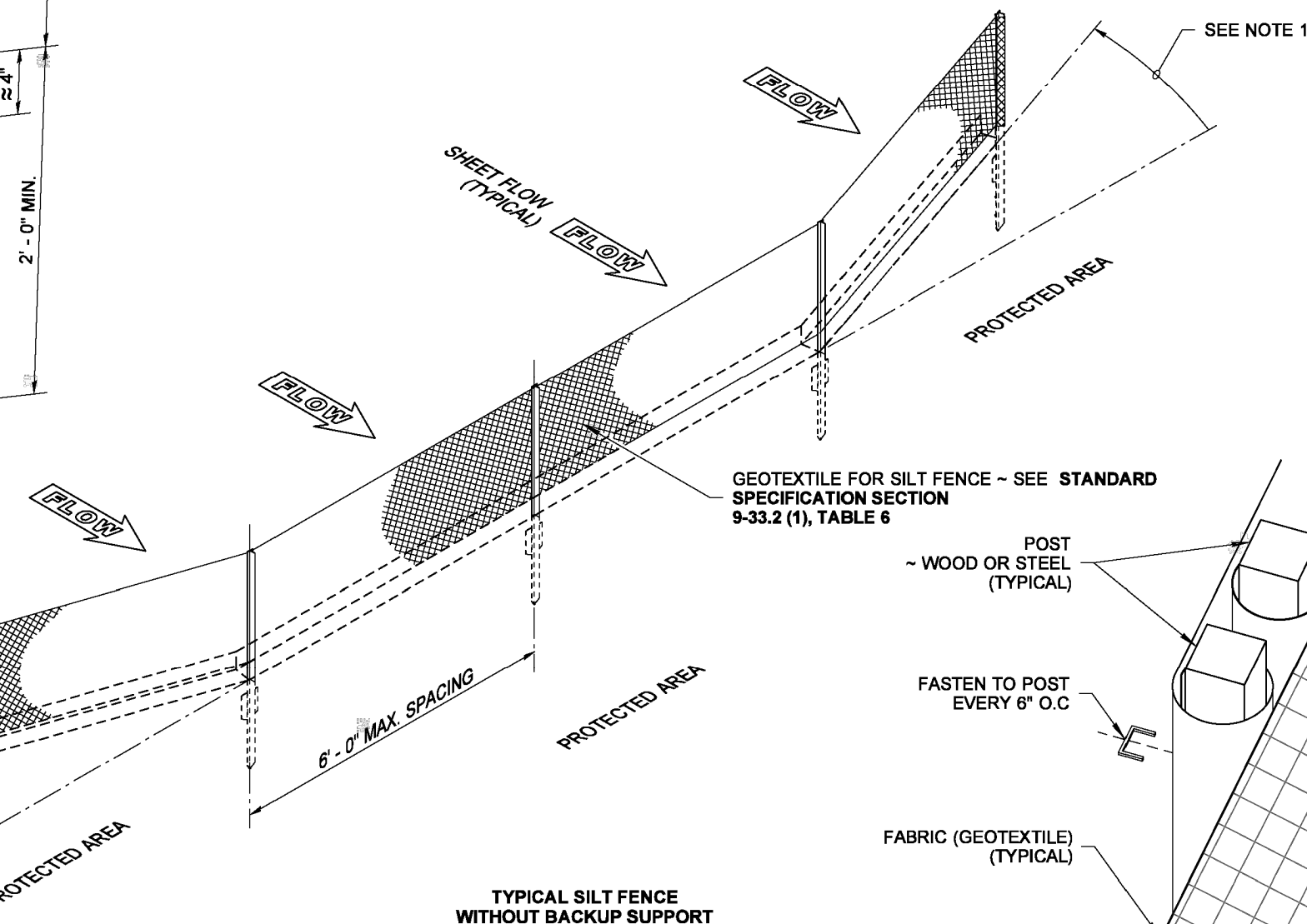

TYPICAL SILT FENCE WITHOUT BACKUP SUPPORT
ISOMETRIC
(STEEL POSTS SHOWN)

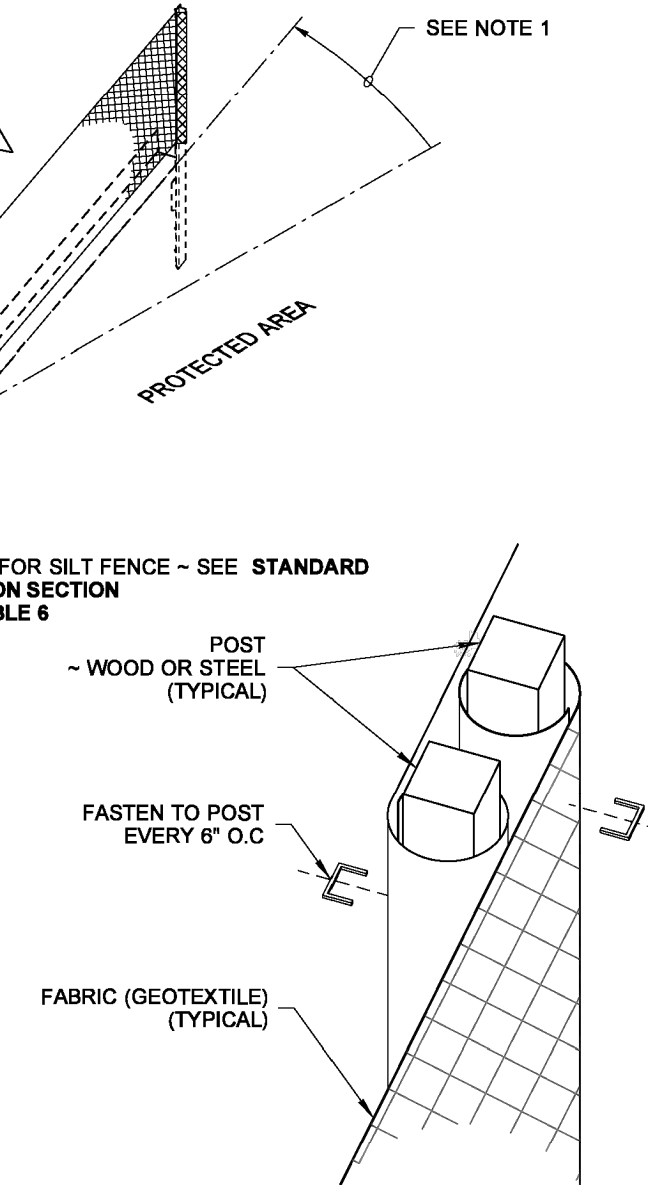

SPLICE DETAIL
(WOOD POSTS SHOWN)

NOTES

1. Install the ends of the silt fence to point slightly upslope to prevent sediment from flowing around the ends of the fence.
2. Perform maintenance in accordance with **Standard Specifications 8-01.3(9)A and 8-01.3(15)**.
3. Splices shall never be placed in low spots or sump locations. If splices are located in low or sump areas, the fence may need to be reinstalled unless the Project Engineer approves the installation.
4. Install silt fencing parallel to mapped contour lines.

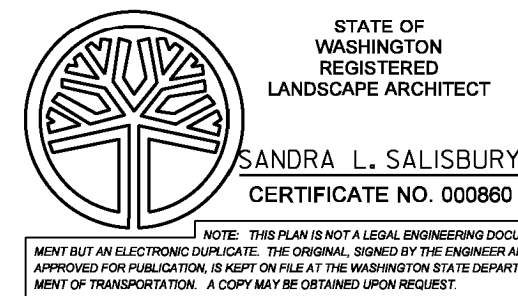

SILT FENCE
STANDARD PLAN I-30.15-02

SHEET 1 OF 1 SHEET
APPROVED FOR PUBLICATION
Pasco Bakotich III 3/22/13
STATE DESIGN ENGINEER DATE
Washington State Department of Transportation

SPLICED FENCE SECTIONS SHALL BE CLOSE ENOUGH TOGETHER TO PREVENT SILT LADEN WATER FROM ESCAPING THROUGH THE FENCE AT THE OVERLAP.

Figure II-3.1: Stabilized Construction Access

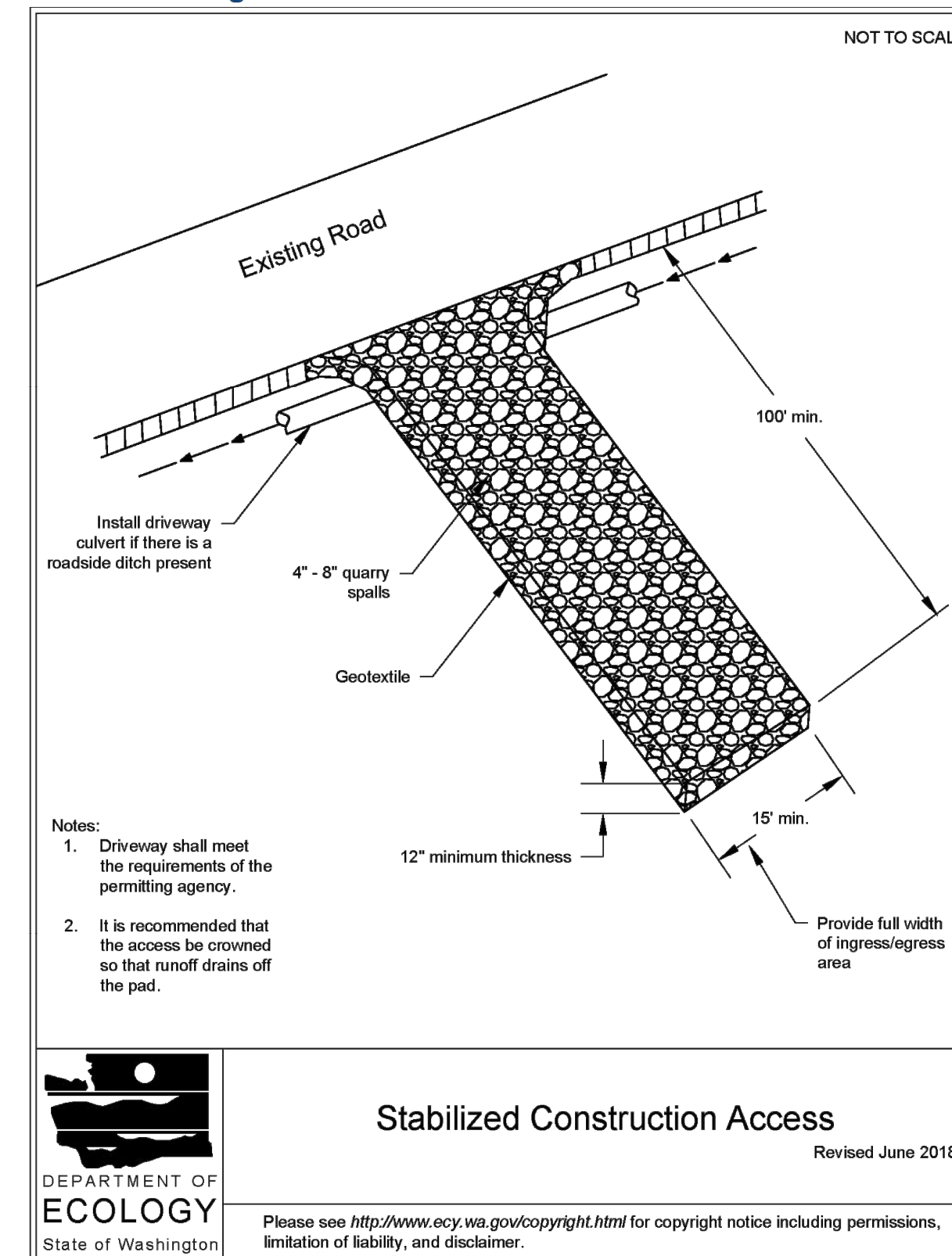

- Notes:**
1. Driveway shall meet the requirements of the permitting agency.
 2. It is recommended that the access be crowned so that runoff drains off the pad.

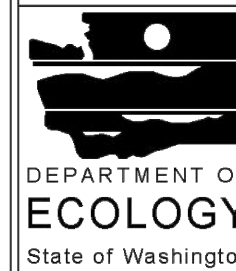

Stabilized Construction Access

Revised June 2018

2019 Stormwater Management Manual for Western Washington

Volume II - Chapter 3 - Page 279

10/31/2025 5:11 PM USER: tony PATH: C:\Projects\10-155-Adams TESC Plan (McFadden)\cad\Adams TESC (2025-10-31).dwg



4218 Meridian Ave N
Seattle, WA 98103
206-898-0057
www.dubinenv.com



NO.	REVISION	BY	DATE	APPR

SURVEYED:	
DESIGNED:	TD
DRAWN:	TD
CHECKED:	
APPROVED:	

SCALE:
1" = 10'
ONE INCH
AT FULL SCALE
IF NOT ONE INCH
SCALE, ACCORDINGLY

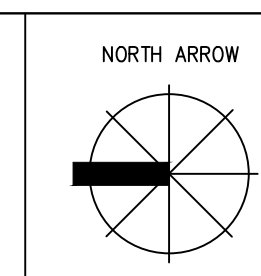
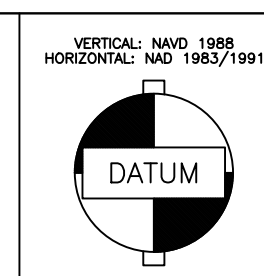

ADAMS RESIDENCE
8035 SE 45TH ST
MERCER ISLAND, WA 98040
PARCEL# 7700100091

TESC DETAILS #1

DATE: 10/31/2025
FIELDBOOK:
PAGE:
DRAWING NO:
SHEET: C-02

DRAWN BY: USA CYFORD

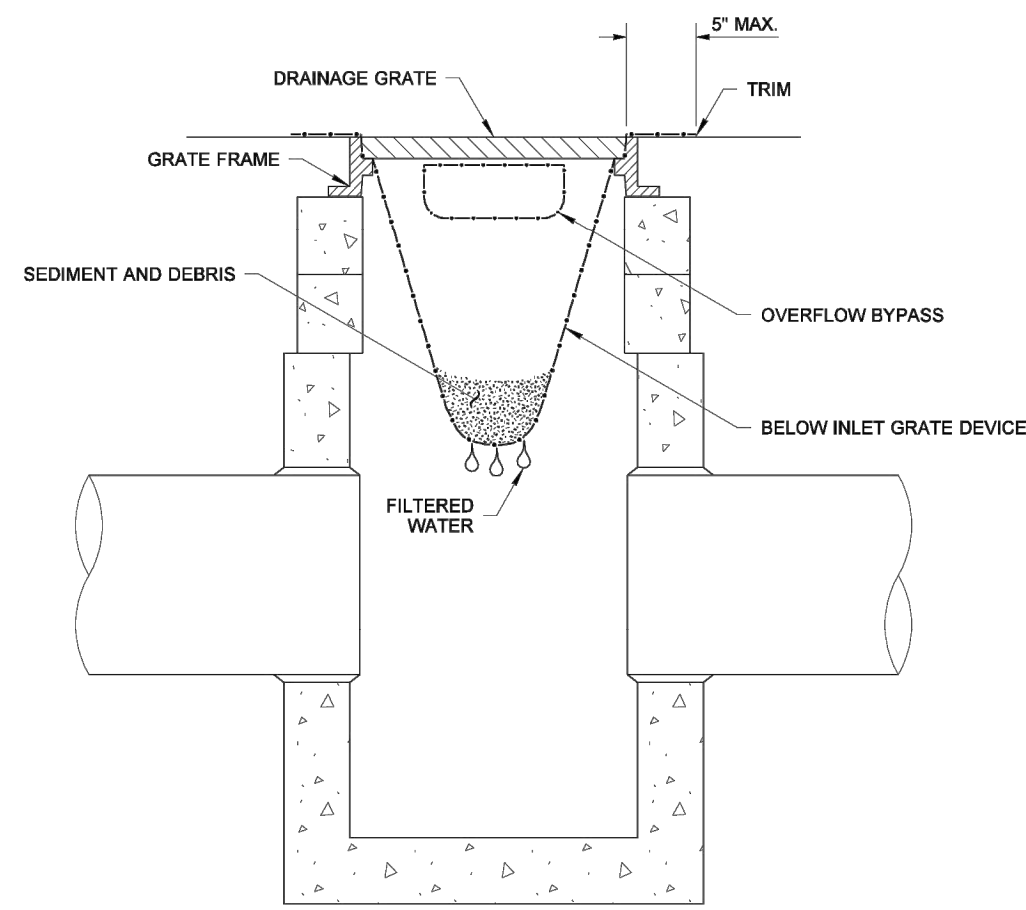

SECTION VIEW
NOT TO SCALE

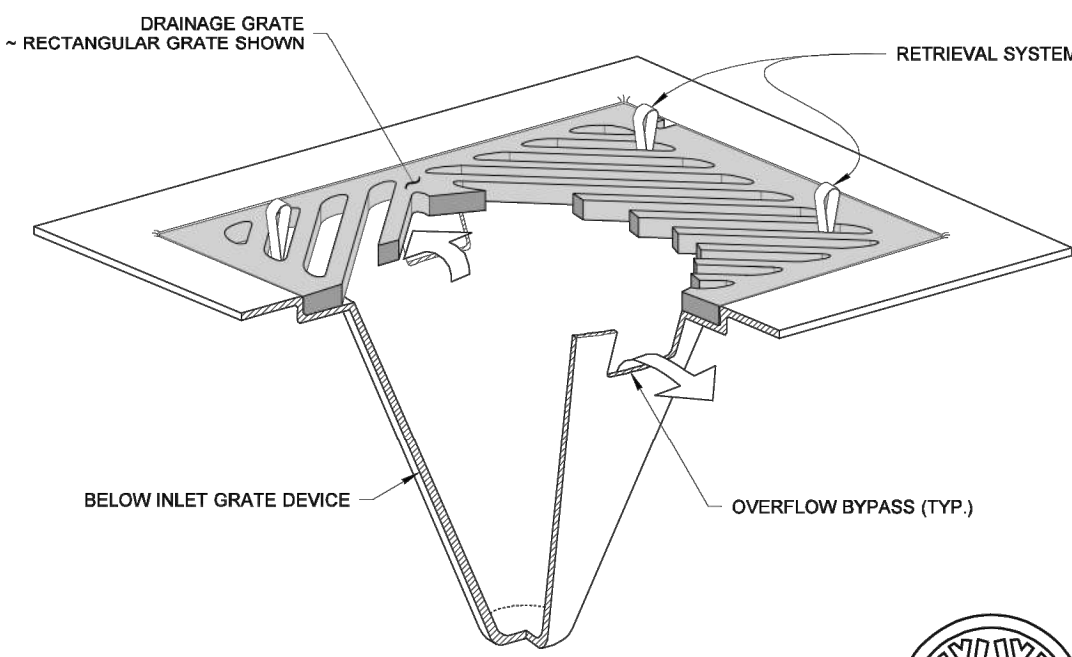

ISOMETRIC VIEW

- NOTES**
1. Size the Below Inlet Grate Device (BIGD) for the storm water structure it will service.
 2. The BIGD shall have a built-in high-flow relief system (overflow bypass).
 3. The retrieval system must allow removal of the BIGD without spilling the collected material.
 4. Perform maintenance in accordance with Standard Specification 8-01.3(15).

STATE OF WASHINGTON REGISTERED LANDSCAPE ARCHITECT

MARK W. MAURER
CERTIFICATE NO. 000598

NOTE: THIS DRAWING IS A LEGAL INSTRUMENT. IT MUST BE USED IN ACCORDANCE WITH THE ORIGINAL, SIGNED BY THE ENGINEER AND APPROVED FOR PUBLICATION. A COPY MAY BE OBTAINED UPON REQUEST.

STORM DRAIN INLET PROTECTION
STANDARD PLAN I-40.20-00
SHEET 1 OF 1 SHEET

APPROVED FOR PUBLICATION
Pasco Bakotich III 09-20-07
STATE DESIGN ENGINEER DATE

Washington State Department of Transportation

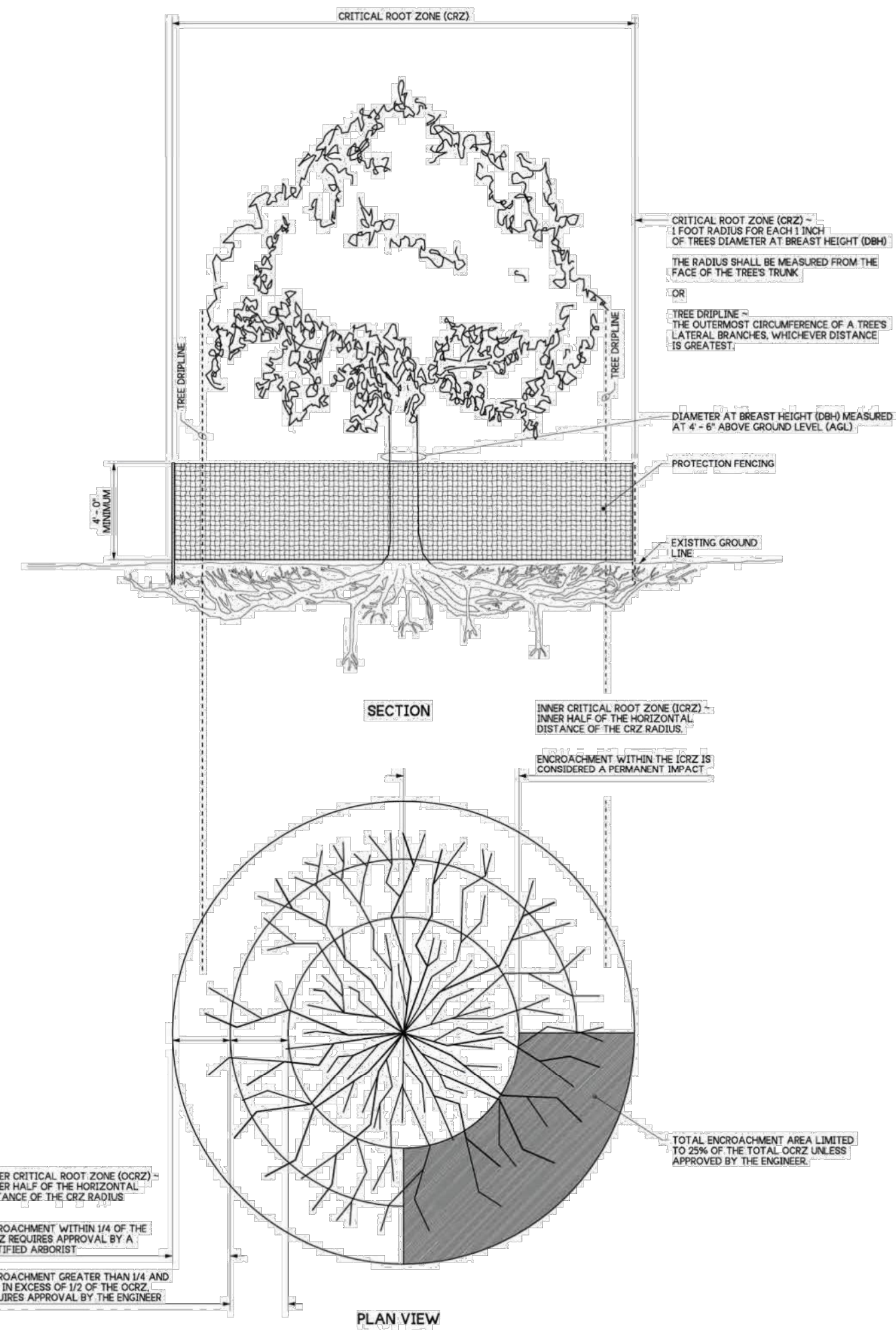

- NOTES:**
1. Limits of protection fencing shall extend to the greatest distance from protected trees trunk as needed to perform the work.
 2. Adjustments to the critical root zone require certified arborist approval. Encroachments within the identified critical root zone requires review approval by a certified arborist.
 3. Protection fencing shown on plans is diagrammatic. All protection fencing locations shall be field verified by the Engineer prior to installation.
 4. Protection fencing shall be inspected by the Engineer after installation for final approval.
 5. Protection measures shall remain intact at all times during construction unless directed otherwise by the Engineer.
 6. See Section 1-07.16(2) for additional protection measures.



May 31, 2024

TREE PROTECTION DETAIL
STANDARD PLAN H-10.11-00
SHEET 1 OF 1 SHEET

APPROVED FOR PUBLICATION
Neil D. Davis Jun 2, 2024
STATE DESIGN ENGINEER

Washington State Department of Transportation

DRAWN BY: FERN LIDDELL

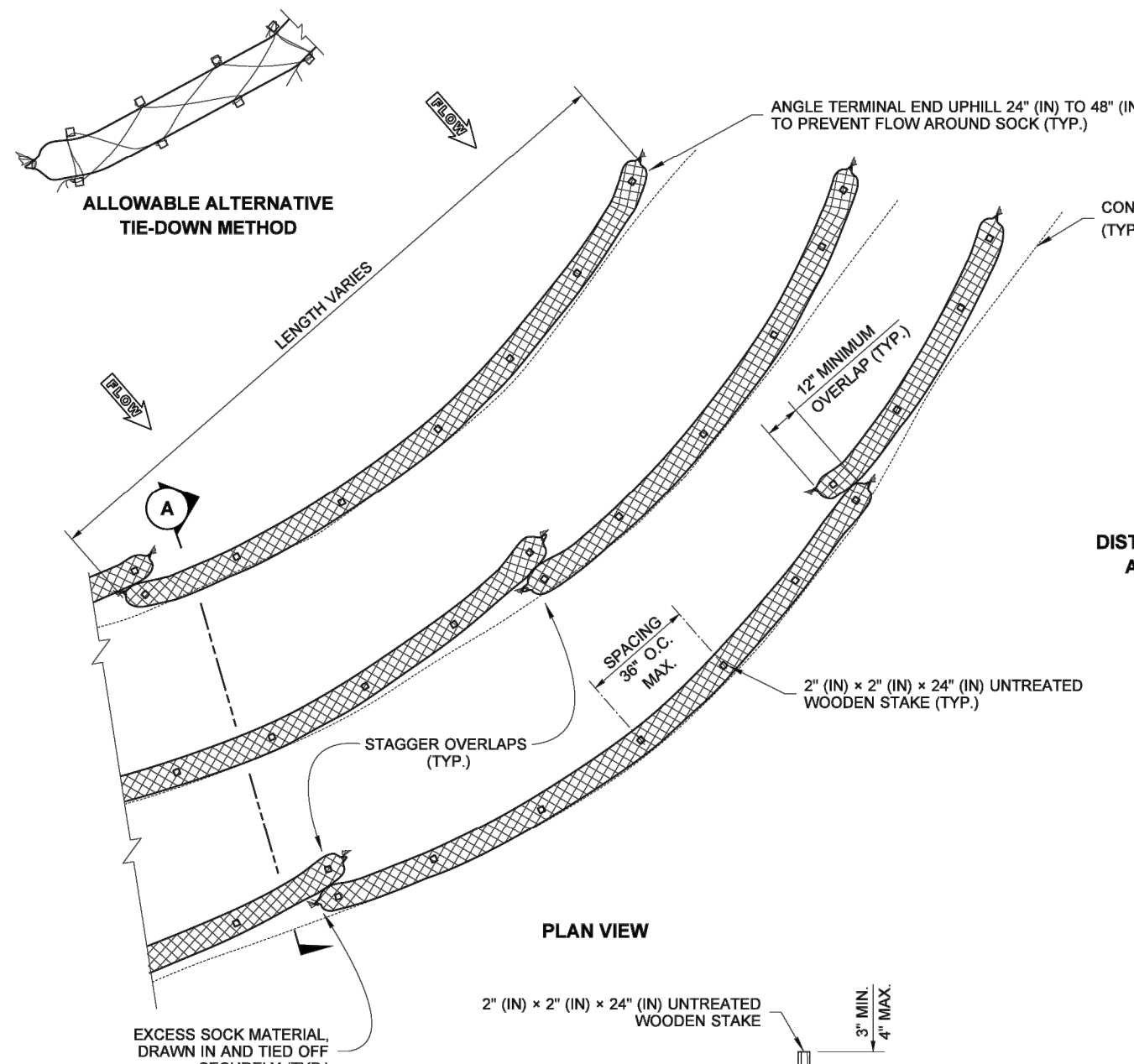

PLAN VIEW

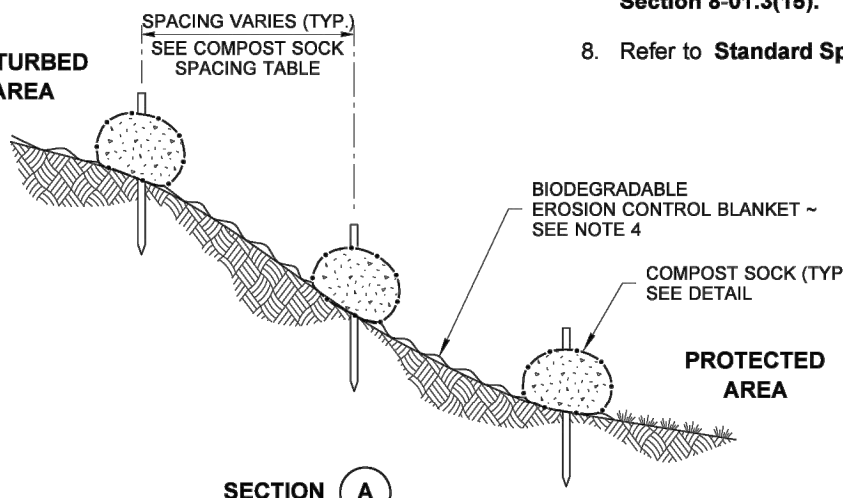

SECTION A

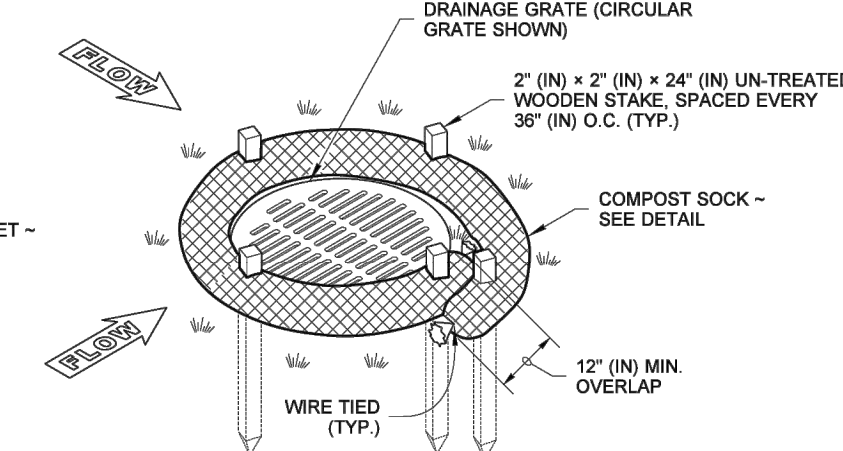

ISOMETRIC VIEW
CATCH BASIN INSTALLATION

- NOTES**
1. Compost Sock shall be in accordance with **Standard Specification, Section 8-14.5(6)**.
 2. Securely knot each end of Compost Sock. Overlap adjacent Compost Sock ends 12" (in) behind one another and securley tie together.
 3. Compost to be dispersed on site as determined by the Engineer, when vegetation covers the surface.
 4. If Erosion Control Blanket is specified, place Compost Sock on top of blanket. See **Standard Plan I-60.10**.
 5. Install Compost Sock perpendicular to flow along contours.
 6. Remove sediment from the up slope side of the Compost Sock when accumulation has reached 1/2 of the effective height of the Compost Sock without compromising the intended function of the Compost Sock per **Standard Specification, section 8-01.3(12)** as determined by the Engineer.
 7. Perform maintenance in accordance with **Standard Specification, Section 8-01.3(15)**.
 8. Refer to **Standard Specification, Section 8-01.3(16)** for removal.



Hartwig, Juli
Jun 4 2019 8:06 AM

COMPOST SOCK
STANDARD PLAN I-30.40-02
SHEET 1 OF 1 SHEET

APPROVED FOR PUBLICATION
Paul Stevens Jun 12 2019 7:41 AM
STATE DESIGN ENGINEER

Washington State Department of Transportation

8" DIAMETER MINIMUM COMPOST SOCK SPACING TABLE

SLOPE	MAXIMUM SPACING
1H : 1V	5' - 0"
2H : 1V	10' - 0"
3H : 1V	15' - 0"
4H : 1V	20' - 0"

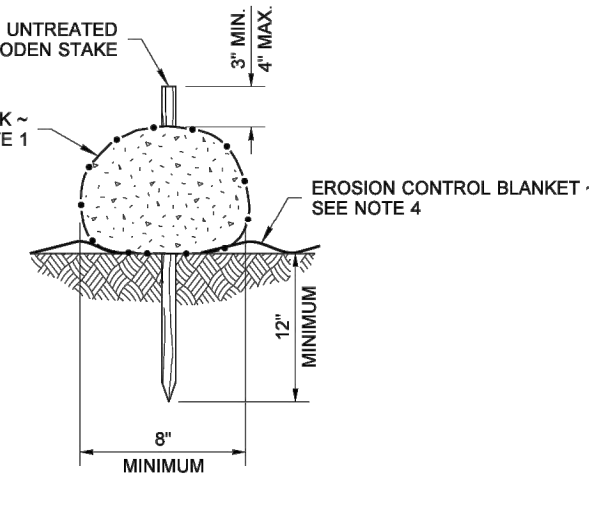

COMPOST SOCK DETAIL

10/31/2025 5:11 PM USER: tony PATH: C:\Projects\10155 Adams TESC Plan (McFadden)\cad\Adams TESC (2025-10-31).dwg



4218 Meridian Ave N
Seattle, WA 98103
206-898-0057
www.dubinenv.com



NO.	REVISION	BY	DATE	APPR

SURVEYED:	
DESIGNED:	TD
DRAWN:	TD
CHECKED:	
APPROVED:	

SCALE:
1" = 10'
ONE INCH
AT FULL SCALE
IF NOT ONE INCH
SCALE ACCORDINGLY

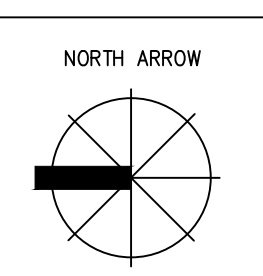
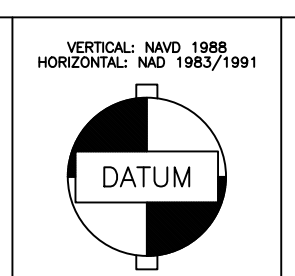

ADAMS RESIDENCE
8035 SE 45TH ST
MERCER ISLAND, WA 98040
PARCEL# 7700100091

DATE: 10/31/2025
FIELDBOOK:
PAGE:
DRAWING NO:
SHEET: C-03

TESC DETAILS #2